



696 N.E. 125th STREET
NORTH MIAMI, FL 33161
Phone: 305.720.2079
C.O.A. 33221



5/25/2022
This item has been digitally signed and sealed by Christopher P. Collins, P.E. on the date adjacent to the seal.

Printed copies of this document are not considered signed and sealed and the signature must be verified on any electronics copies.



Revision	Date	Comment
Revision	Date	Comment
Revision	Date	Comment
Revision	Date	Comment
Revision	Date	Comment
Revision	Date	Comment
Revision	Date	Comment

Designed by:	C.P.C.
Drawn by:	A.T.S.
Checked by:	C.P.C.
Approved by:	C.P.C.
Scale:	1" = 20'
Date:	05/25/2022

Job No.: I002

Plans for
FESTIVAL MARKETPLACE
2900 W SAMPLE ROAD
POMPANO BEACH, FLORIDA

GRADING BLOW UP PLAN

Christ
opher
Collin
s
Digitally signed by Christopher Collins
Date: 2022.07.14 12:38:55 -05'00'

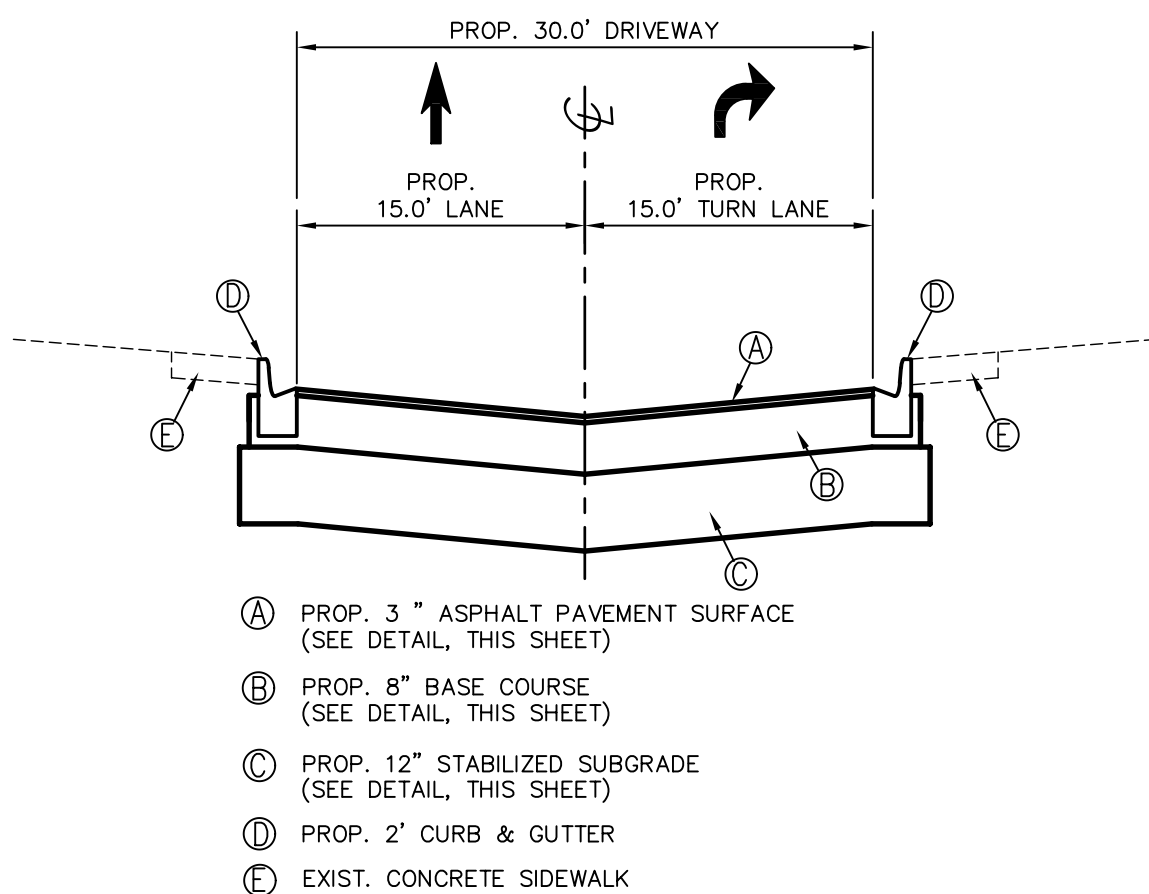
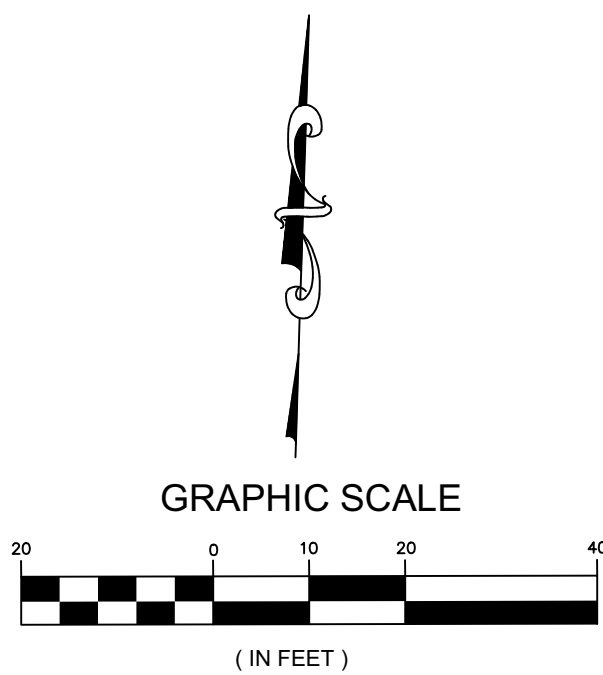

SAMPLE ROAD
PROPOSED NEW DRIVEWAY CROSS SECTION "B"-"B"
SCALE: HOR. 1"=10'
VERT. 1"=4'

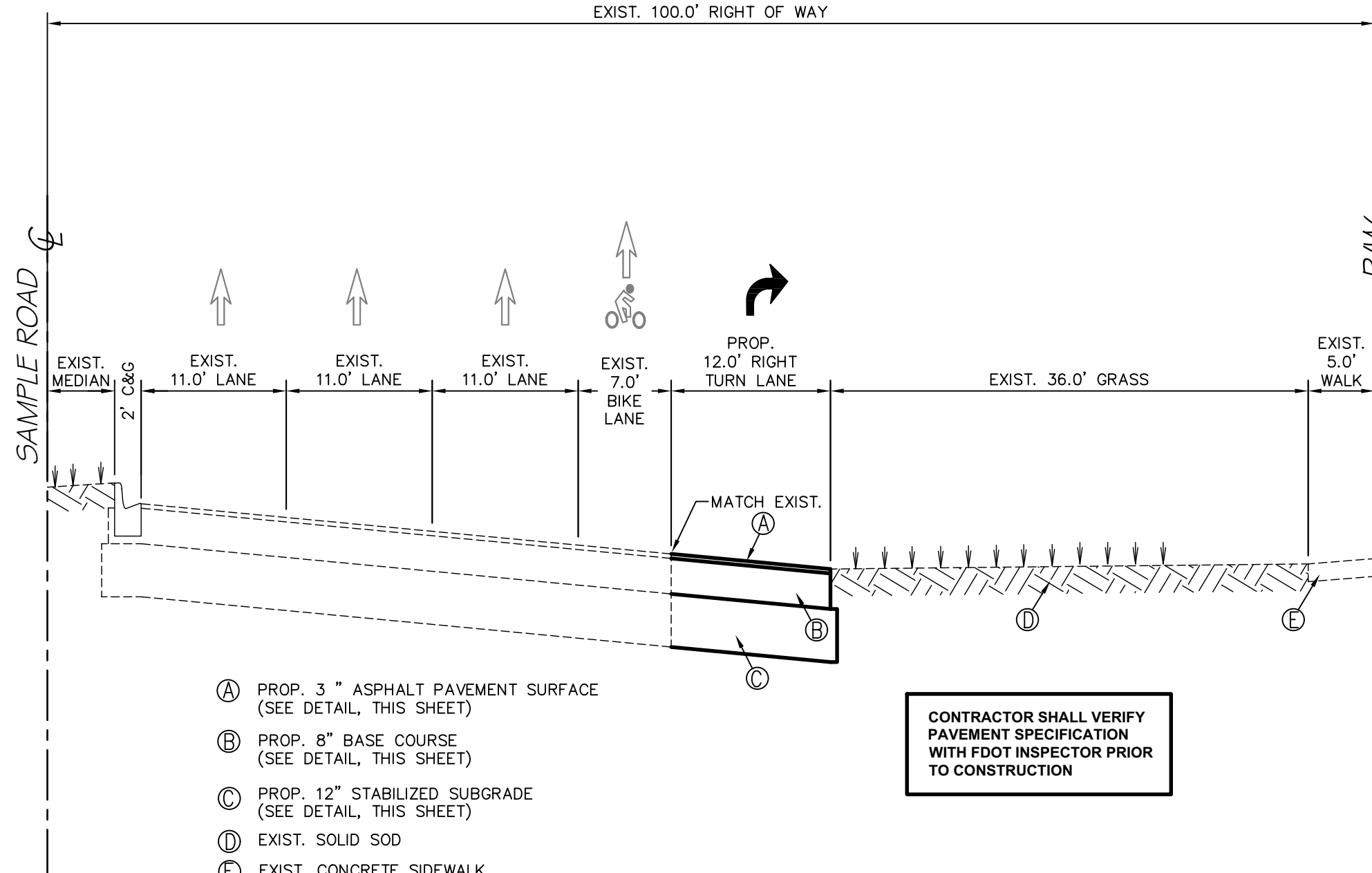

SAMPLE ROAD
PROPOSED NEW DRIVEWAY CROSS SECTION "A"-"A"
SCALE: HOR. 1"=10'
VERT. 1"=4'

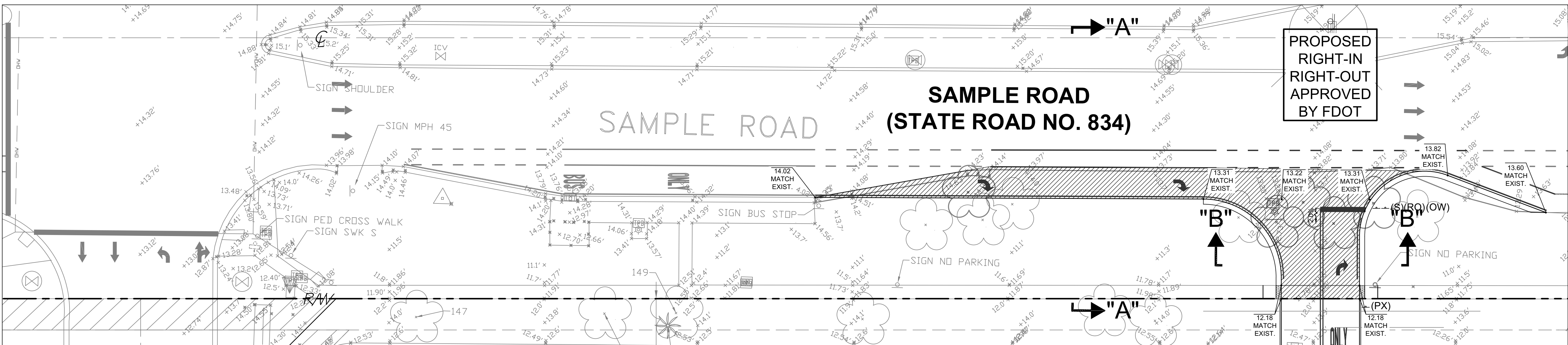

SITE SYMBOLS /LEGEND

- (E.P.) EDGE OF PMT. ELEV. OR GROUND ELEV.
- X% PROP. FLOW DIRECTION AND SLOPE
- +14.40' EXIST. GRADE ELEVATION

HATCH LEGEND

- EXISTING CONCRETE SIDEWALK
- PROPOSED NEW PAVEMENT. CONTRACTOR SHALL MATCH EXISTING PAVEMENT PER FDOT STANDARDS SPECIFICATIONS

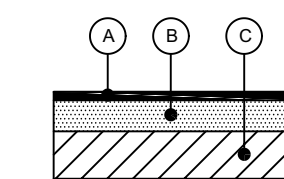

- A 3" OPTIONAL BASE GROUP 9 (OB9), ASPHALT SHALL BE PLACED IN TWO (2) LIFTS: 2" OF SP-12.5 AND 1" OF SP-9.5.
- B 6" CRUSHED LIMEROCK BASE COURSE HAVING A MINIMUM LBR OF 100 AND MINIMUM CARBON CALCIUM CONTENT 70% COMPACTED TO AT LEAST 98% OF THE MODIFIED PROCTOR MAXIMUM DRY DENSITY PER ASTM D-1557, PLACED IN (2) LIFTS, PER MG. PV.
- C TYPE B OR C 12" STABILIZED SUB-BASE FILLED WITH MINIMUM LBR OF 40 COMPACTED TO AT LEAST 98% OF THE MODIFIED PROCTOR MAXIMUM DRY DENSITY PER ASTM D-1557.

FDOT PAVEMENT DETAIL

N.T.S.

PERMIT SET
MUST BE ON JOBSITE AT ALL TIMES DURING CONSTRUCTION

NOTICE
INSPECTION REQUIRED
24 HRS. PRIOR TO COMMENCING ANY WORK IN THE PUBLIC ROW CONTACT THE BROWARD COUNTY HIGHWAY CONSTRUCTION AND ENGINEERING DIVISION AT 954-577-4600 FOR INSPECTION.

NOTE:
APPROVAL OF THIS PLAN DOES NOT CONSTITUTE A PERMIT FOR CONSTRUCTION.

A PERMIT FOR CONSTRUCTION MUST BE OBTAINED FROM THE BROWARD COUNTY HIGHWAY CONSTRUCTION AND ENGINEERING DIVISION PRIOR TO COMMENCING CONSTRUCTION IN THE PUBLIC RIGHT OF WAY.

ALL MATERIALS USED AND INSTALLATIONS WITHIN THE PUBLIC RIGHT OF WAY OR EASEMENTS SHALL BE IN ACCORDANCE WITH BROWARD COUNTY HIGHWAY CONSTRUCTION AND ENGINEERING DIVISION SPECIFICATIONS.

BROWARD COUNTY HIGHWAY CONSTRUCTION AND ENGINEERING DIVISION

- ☐ PLAN CONSISTENT WITH PLAT REQUIREMENTS
- ☐ PUBLIC RIGHT OF WAY APPROVAL FOR PAVING, GRADING AND DRAINAGE

BY: DATE: DOES NOT INCLUDE APPROVAL OF PAVEMENT MARKING & SIGNS

sunshine
Call 8... visit sunshine.com... full business days before...
Check positive response codes before you dig!

PZ22-12000027
8/17/2022